

Installation- and Operating Instructions



PC-230

Art. No. 300.270.0010

Not suitable for filter pumps with speed control

Functioning:

The osf filter control system PC-230 enables time-controlled connection and disconnection of a 230V A.C. filter pump. Setting of the daytime and the individual response times can be noted from the corresponding operating instructions of the automatic switch which is enclosed. By means of the selector switch in the front cover it is possible to:

- a) Switch on and off the functioning of the unit. **Attention, the control system is thus not disconnected from the mains supply at all poles!**
- b) to switch the unit to permanent operation or automatic operation (automatic switch) of the filter pump.

Also during the working time of the filter pump, the heating of the pool is regulated by the external temperature control. During interruptions of the filtering process, the heating is automatically switched off by the internal locking device.

Operation of the filter pump and the heating is displayed by indicator lamps in the front cover - controlling is therefore possible at any time.

Connection terminals for an electronic level control **osf**-NR-12-TRS-2 (Art. No. 303000020) ensure a comfortable automatic control of the water level in the pool. Additionally, the filter pump is protected against damage which may arise due to operation of the filter unit without water.

Connection terminals for an **osf**-EUROTRONIK-10 (Art. No. 3104800200) ensure an enlargement of the filter control to an automatic filter- and re-flushing control.

Technical Data:

Dimensions:	220mm x 219mm x 100mm	
Operating voltage:	230V/50Hz	
Power consumption of the control system:	abt.1.5VA	
Not suitable for filter pumps with speed control		
Capacity:	Pump:	max. 1.0 kW (AC3)
	Heating:	max. 0.4 kW (AC1)
Type of protection:	IP 40	

Installation:

For installation, the control unit has to be protected against humidity, according to its type of protection. The power supply of the unit has to be affected by an all-pole main switch with a contact gap width of a minimum of 3mm. **Before opening the housing, the unit has to be switched free of electrical tension by all means.**

Electrical connection:

The electrical connection as well as alignment- and service works shall only be carried out by a qualified specialist electrician! The following cable arrangement and the corresponding safety instructions in force shall be observed.

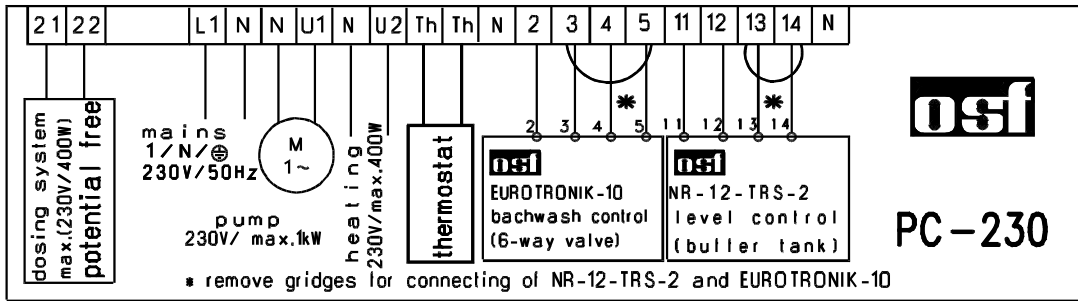

The bridge which is installed by the manufacturer between the terminals 13 and 14 has to be removed if a level control unit **osfi** NR-12-TRS-2 is connected. If a level control unit is not connected, the bridge has to remain bolted between these terminals. In this case, the terminals 11 and 12 shall not be used.

The bridge which is installed by the manufacturer between the terminals 5 and 3 has to be removed, if an **osfi** EUROTRONIK-10 is connected. If an EUROTRONIK-10 is not connected, the bridge between these terminals has to remain in place. In this case, the terminals 2 and 4 shall not be used

A **potential-free contact** is available at the terminals 21 and 22 for connection to the dosage system. This contact is closed as long as the filter pump is in operation.

Overall current consumption of the filter pump and the heating shall not exceed 10A. The electronic control system and the connected pump and heating are jointly protected by a 10A fine-wire fuse I. The filter pump and the heating are not separately protected by fuse. Short circuit protection is to be ensured by suitable fuses in place.

Operation of the timer

Set the timer

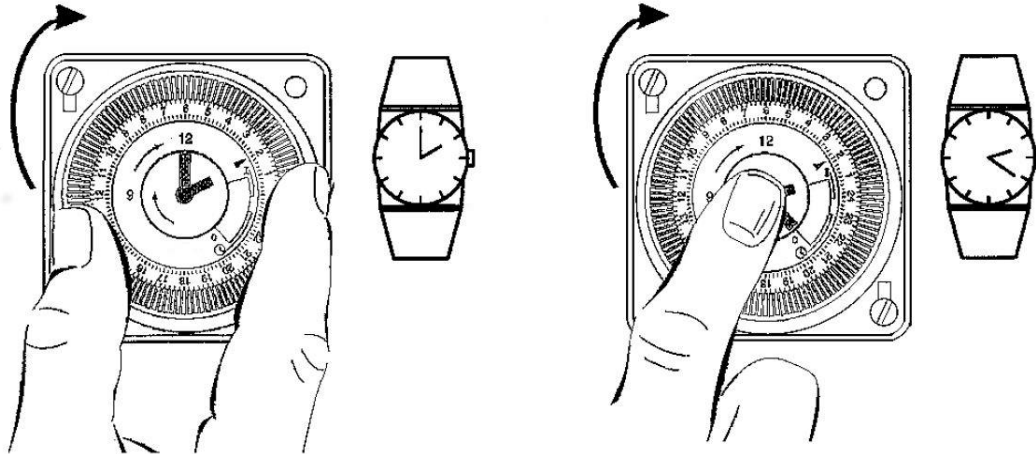

Set switching time

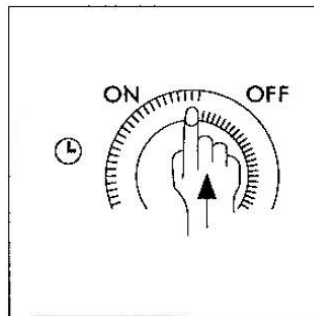

Further information can be found on the Internet at the following address:
<https://osf.de/download/documents/doclist.php?device=PC-230&subdir=none>

